

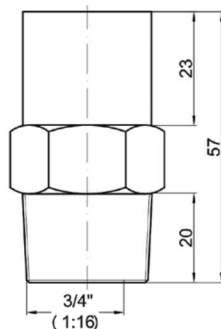
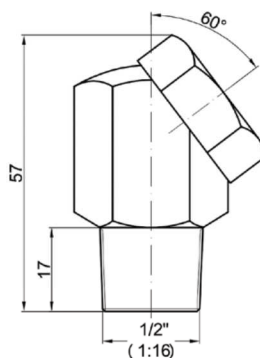
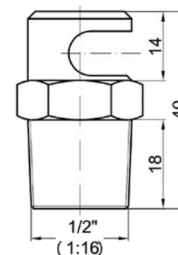

MR

MKO

MK

APPLICATION

Water nozzles have a wide application and mostly they are used:

- For cooling storage facilities, industrial plants, oil, chemical and process refineries and all other facilities which needs creation of adequate climate conditions or in the purpose of fire safe water curtains
- For putting out fires in warehouses and industrial objects with the use of dry or wet systems
- For spraying water in the agro industry, humidifying and creating adequate climate conditions in green houses
- For humidifying air in industrial climate chambers, atomizers and alike

DESIGN FEATURES

It is made from brass CW614N (CuZn39Pb3)

The orientation values on the necessary amounts of water depend on the pressure, the number of nozzles and their distance from the put out or protection zone:

- For putting out fires 7-30 l/m², min
- For localizing fires 6-16 l/m², min
- For cooling facilities 10 l/m², min

water flow in litres/min

CODE	type	pressure (bar)											spraying angle	WEIGHT (kg)
		1	1.5	2	3	4	5	6	7	8	9	10		
070301	MR-1			24.5	28	32	35	38	41	43.5	46	48	120°-125°	0.18
070401	MKO-3.5			5.5	7.5	9	10	11					100°-120°	0.16
070402	MKO-5			10.2	12.6	15	16.4	18					100°-120°	0.16
070403	MKO-6.5			16	19.5	23	26	29					90°-120°	0.16
070404	MKO-8			17	22	25.2	28	32					100°-120°	0.16
070501	MK-4.5			12	15	18	21	24					160°-170°	0.10
070502	MK-5	4.1		8.2	12.7	17	20	22.3	24.5	26.5	28		160°	0.10
070503	MK-6.5	15		22.5	30	35	40	44	47	52			160°	0.10
070504	MK-7	17.5		25.5	33	37	42	47	51	54			160°	0.10